

Penn State University

# Tech Report 1A Part 1: Lighting Proposal Memo

The HUB Addition

John C Keyes  
9-9-2015

# Tech Report 1: Lighting Proposal Memo

## Proposed Areas of Study

### SPECIAL PURPOSE SPACE | FOOD COURT AND SEATING AREA

This space houses several food vendors and acts primarily as a retail space where people can browse and buy what they want. The main concern is the ability for people to easily navigate through the space to areas of interest. Once through the food court itself, it opens up into a large seating area that connects to the main atrium space. Here occupants can eat, study, or socialize.

**Due to this spaces' unique purposes, I will perform a psychological impression study on it.**

#### MATERIALS:

Walls: Painted GWB

Roof: Steel and wood planks

Floors: Concrete and plastic laminate

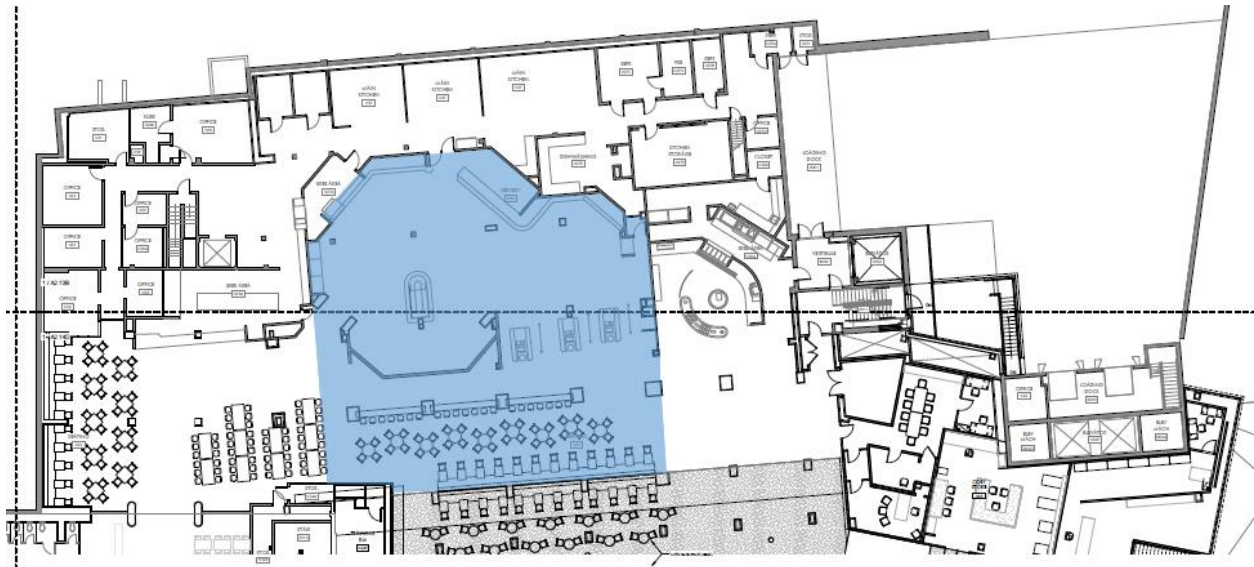

Figure 1 | Food court and seating area

# Tech Report 1: Lighting Proposal Memo

## CIRCULATION SPACE | LARGE ATRIUM SPACE



*Figure 2 | Interior render of atrium space*

The atrium's primary use is seating, for the food area, and circulation. This space connects the east entrances as well as the parking deck traffic to the rest of the HUB. There is also a gathering space that connects the 1<sup>st</sup> floor to the mezzanine level, which features both stairs and bleacher style seating. At times of lower traffic, it could act as a gathering space as well for various clubs or other student activities.

### **MATERIALS:**

Walls: Terra cotta, aluminum curtain wall, and painted GWB

Roof: Stainless steel and glass

Floors: Concrete and wood sheeting

# Tech Report 1: Lighting Proposal Memo

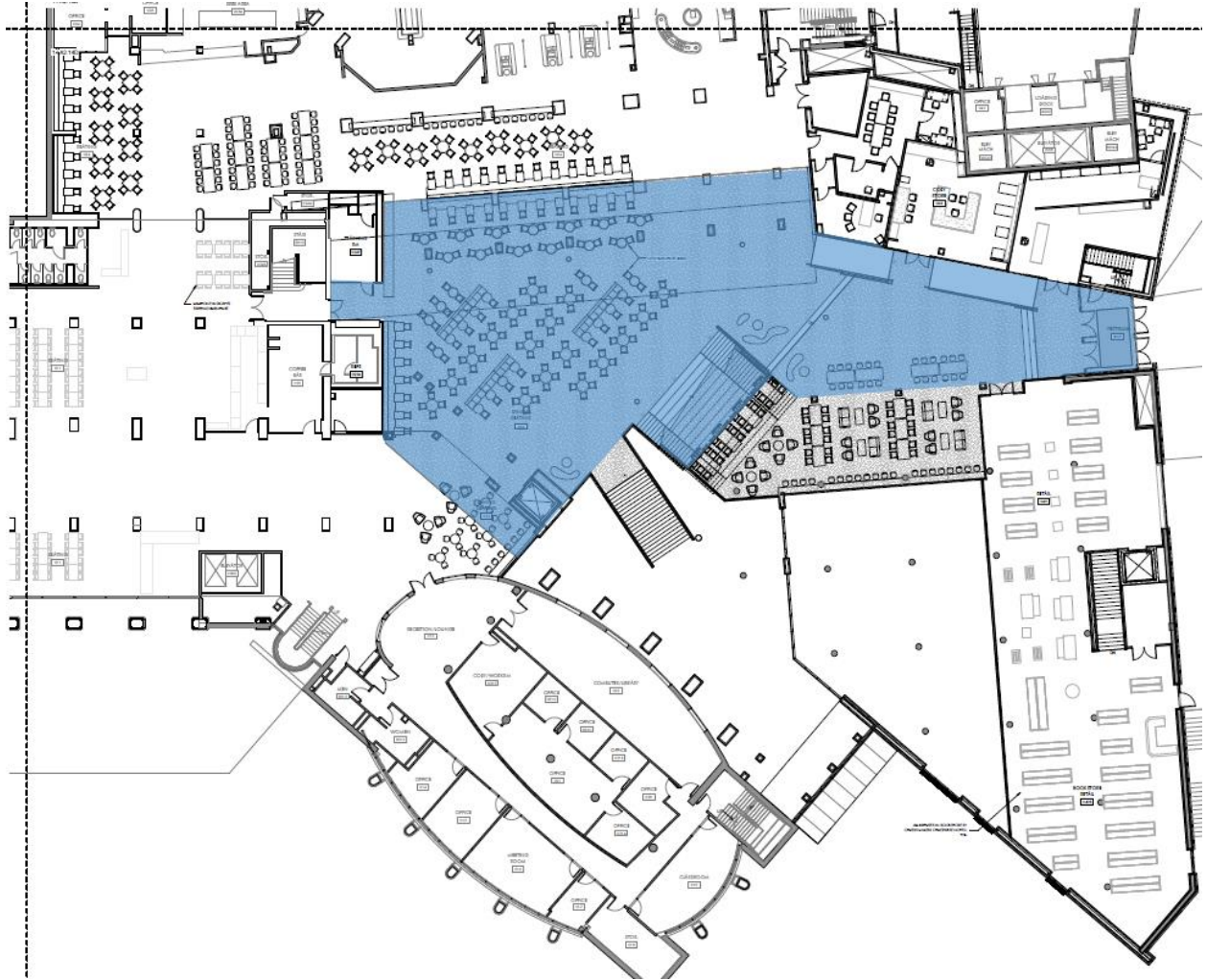

Figure 3 | Atrium space

# Tech Report 1: Lighting Proposal Memo

## OUTDOOR SPACE OR FAÇADE | GREEN ROOF

The green roof is a gathering and lounge area, where occupants would come primarily to relax, study, or engage in a low activity task. It features benches on the perimeter of the paved area designated for occupant use. Due to its unique location, use, and possibilities, I have decided to design three schematic designs for this space.

### MATERIALS:

Walls: Terra cotta and aluminum curtain wall

Floors: Gravel and masonry brick

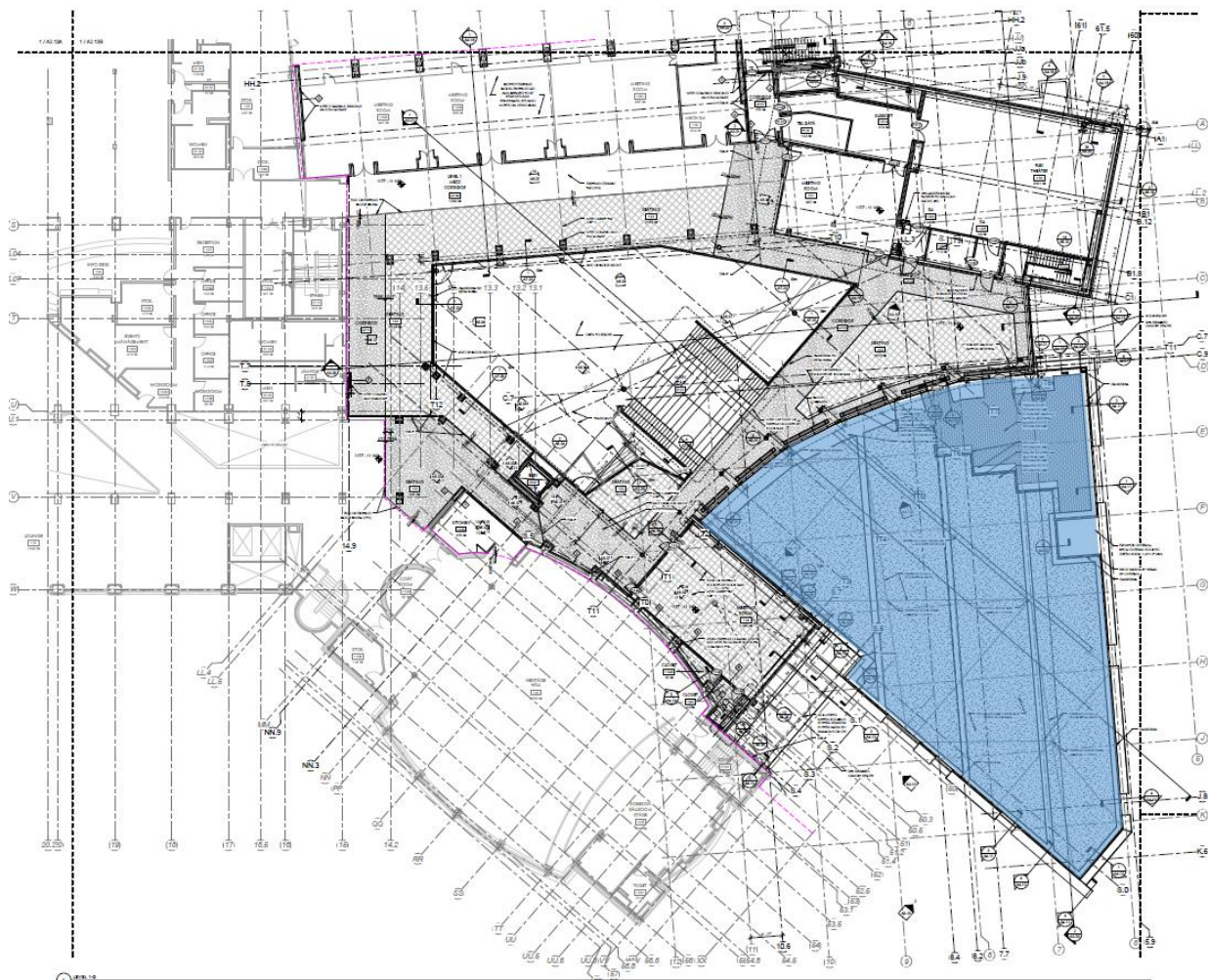

Figure 4| Green roof area with relation to the main atrium space

# Tech Report 1: Lighting Proposal Memo

## LARGE WORK SPACE | BOOKSTORE

The bookstore is a large open retail area. The entrance is open to the second story, creating a clear entryway into the space. Most of the products are on the first floor with the book section in a separate space in the back. The mezzanine level has a small library and reading area. The space would be used for shopping, reading, and studying.

### MATERIALS:

Walls: Painted GWB and aluminum curtain wall

Roof: Acoustic ceiling tile and concrete

Floors: Concrete

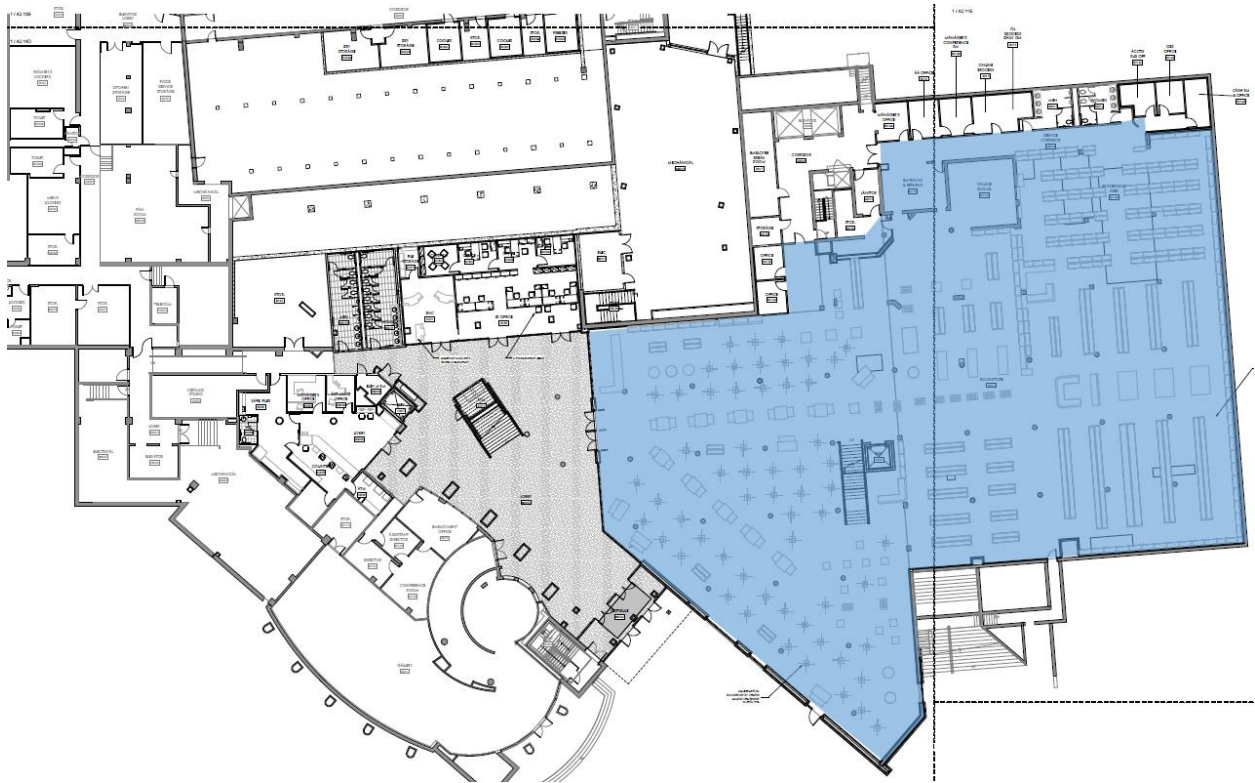

Figure 5| Bookstore in relation to the main southeast entrance